

Powermaster SG Explosion View

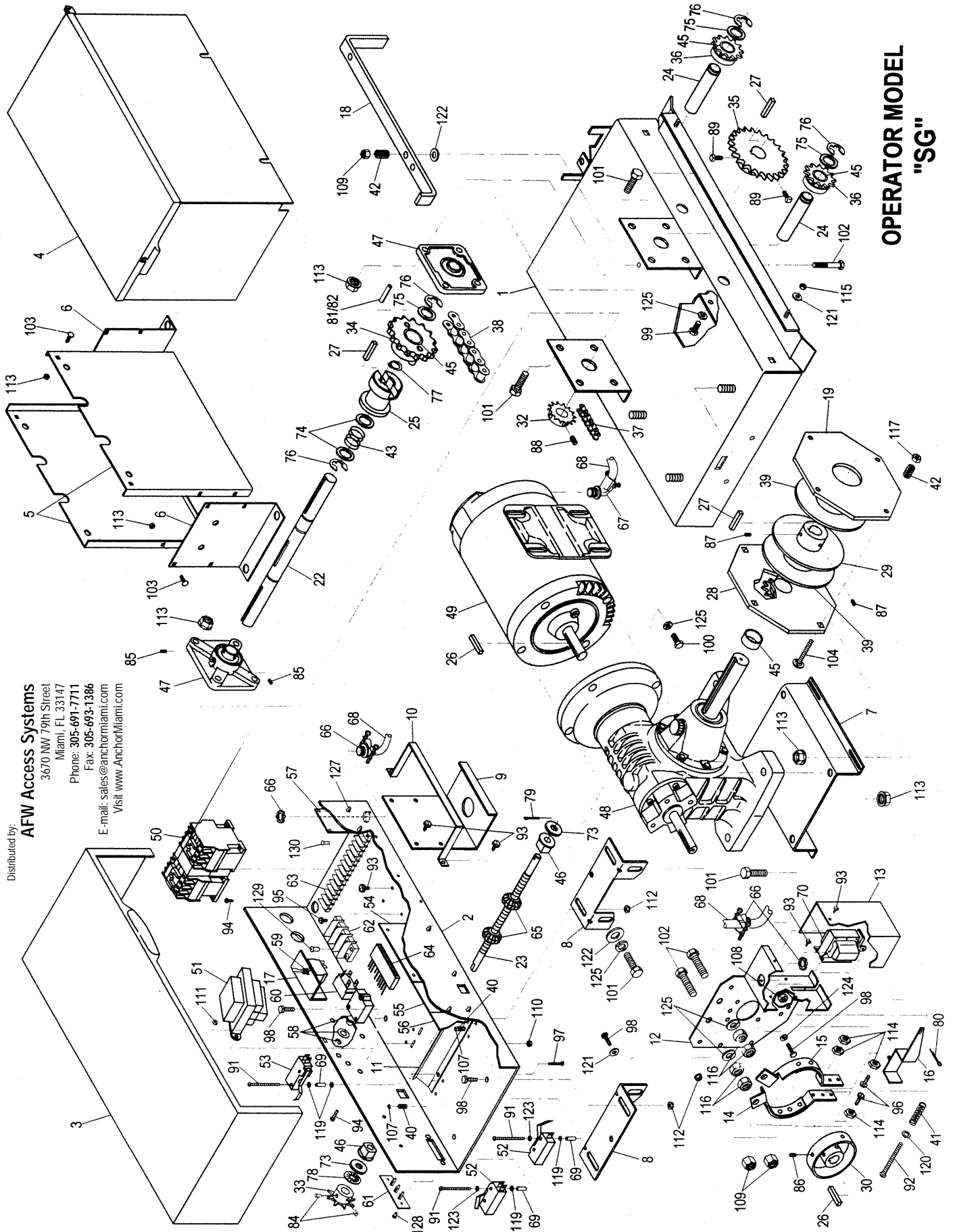

**OPERATOR MODEL
"SG"**

Distributed by:
AFW Access Systems
3670 NW 79th Street
Miami, FL 33147
Phone: 305-691-7711
Fax: 305-693-1386
E-mail: sales@anchormiami.com
Visit www.AnchorMiami.com

SG

ITEM	QTY.	DESCRIPTION	PART #
1	One	Base frame weldment	2304
2	One	Electric chassis	2301
3	One	Electric chassis cover	2302
4	One	Cover with hinged top	2307
5	Two	Mounting leg	2305
6	Two	Mounting foot	2306
7	One	Reducer mounting bracket	2303
8	Two	Universal bracket	U-101
9	One	Shelf bracket	SG-112
10	One	Loop detector retaining bracket	SG-26
11	One	Limit nut retainer plate	H-110
12	One	Brake backing plate	2102
13	One	Solenoid cover	2105
14	One	Left brake shoe	2101-1
15	One	Right brake shoe	2101-2
16	One	Brack actuator arm	2104
17	One	Left/right switch bracket	2320
18	One	Disconnect lever	2310
19	One	Pressure plate	CSW-1030
20			
21			
22	One	Keyed disconnect shaft	SG-104
23	One	Limit shaft	H-1014
24	Two	Idler shaft	2501
25	One	Brass slide	SG-102
26	Two	3/16" Square key	SK316X1.375
27	Three	1/4" Square key	SK14X1.250
28	One	Cluster weldment	SG-1035-15
29	One	Drive plate weldment	CSW-1029
30	One	Brake wheel	2103
31			
32	One	Limit drive sprocket	48B14X1
33	One	Limit driven sprocket	48B7X.375
34	One	Disconnect pinned sprocket	5015X125
35	One	Output drive sprocket	5024X1
36	Two	Idler sprocket	50B12X125
37	One	Limit chain	6551
38	One	Intermediate drive chain	50X35
39	Two	Clutch disk (fiber)	CSW-1034
40	Two	Spring	LC045D3
41	One	Spring	LC045E11MW
42	Five	Spring	C-120
43	One	Spring	C1225096
44			
45	Four	1" Plain bearing	PB1002

SG

ITEM	QTY.	DESCRIPTION	PART #
46	Two	3/8" Flange bearing	FB375
47	Two	1" Four bolt flange bearing	UCFS20720
48	One	Gear reducer (up to 1 H.P.)	VE-55
		or Gear reducer (1-1/2 to 2 H.P.)	VE-70
49	One	Motor	AS REQ'D
50	One	Contactor	LC2D0910
51	One	1 \emptyset Transformer	T112-2460V
		or 3 \emptyset Transformer	T4-2460V
52	Two	Limit switch	LS-AT
53	One	B1~Limit switch	LS-AT-B1
54	One	PC Control board	TPU
55	One	Diagnostic board (optional)	SS6D
56	One	S/F Timer (Optional)	ACT
		or D/F timer (optional)	FAL5582ACTW
57	One	Current senser board (optional)	5582CC55
58	One	1 \emptyset Overload reset switch	MB-AS REQ'D
		or 3 \emptyset Overload reset switch	LR-2-AS REQ'D
59	One	Left/right Switch	2GX53-73
60	One	On/off switch	2GK51-73
61	One	3 Position R/C terminal strip	TS-03
62	One	3 Position terminal block	TB-03
63	One	14 Position terminal strip	TB-114
64	One	12 Pin wiring harness	12P-HARN
65	Two	Limit nut	L-100
66	Two	3/8" Straight connector	501-DC2
67	One	3/8" 90° Connector	801-DC2
68	Two	Insulating tubing	PVI-024
69	Six	Limit switch spacer	60233
70	One	Brake solenoid 120V	4X240
		or Brake solenoid 240V	4X894
71			
72			
73	Two	3/8" Shim	375X050
74	As Req.	1" Shim (thin)	1X0.016
75	As Req.	1" Shim (thick)	1X0.05
76	Four	1" E-ring	SE-98-01
77	One	1" External retaining ring	SH-100STPA
78	One	Push-on retaining ring	PS-375012
79	One	Cotter pin	C093X1
80	One	Cotter apin	C125X1
81	Two	1/4" Roll pin	R25X1
82	Two	3/8" Roll pin	R375X1
83			
84	Two	Socket set screw	1104SSC
85	Four	Socket set screw	1404SSC

SG

ITEM	QTY.	DESCRIPTION	PART #
86	Two	Socket set screw	1405SSC
87	Two	Socket set screw	3105SSC
88	One	Socket set screw	3110SSC
89	Two	Square head set screw	SQS51618X75
90			
91	Six	Pan head machine screw	0624MSP
92	One	Round head machine screw	1140MSR
93	Eleven	Hex washer head, type B, sheet metal screw	0804BSW
94	Four	Hex washer head machine screw	0808MSW
95	One	Hex washer head machine screw (green)	1106MSW
96	Two	Hex washer head machine screw	1110MSW
97	Two	Hex head machine screw	01616MH
98	Ten	Hex head tap bolt	1410BHT
99	Two	Hex head tap bolt	3712BHT
100	Two	Hex head tap bolt	3716BHT
101	14	Hex head tap bolt	3720BHT
102	Three	Hex head cap bolt	3732CH2
103	Twelve	Carriage bolt	3716C
104	Four	Carriage bolt	3736C
105			
106			
107	Two	Nylon insert stop nut	06NS
108	One	Nylon insert stop nut	14NS
109	Three	Nylon insert stop nut	37NS
110	Two	Serrated flange hex nut	06NR
111	Two	Serrated flange hex nut	08NR
112	Six	Serrated flange hex nut	14NR
113	28	Serrated flange hex nut	37NR
114	Four	Hex nut	11NH
115	Four	Hex nut	14NF
116	Four	Hex nut	37NF
117	Four	Hex jam nut	37NJ
118			
119	Eight	Flat washer	06WSAE
120	One	Flat washer	10WSAE
121	Six	Flat washer	14WSAE
122	Three	Flat washer	37WSAE
123	Four	Lock washer	06WS
124	Four	Lock washer	14WS
125	Eight	Lock washer	37WS
126			
127	Eleven	Stand Off	PS0-14
128	Two	Rivet	1624-0041
129	Two	Rivet	BF01-0630
130	Two	Rivet	SD-46BS