

# Powermaster SGI 2000 Exploded View

**OPERATOR MODEL  
"SGI" (Series 2000)**

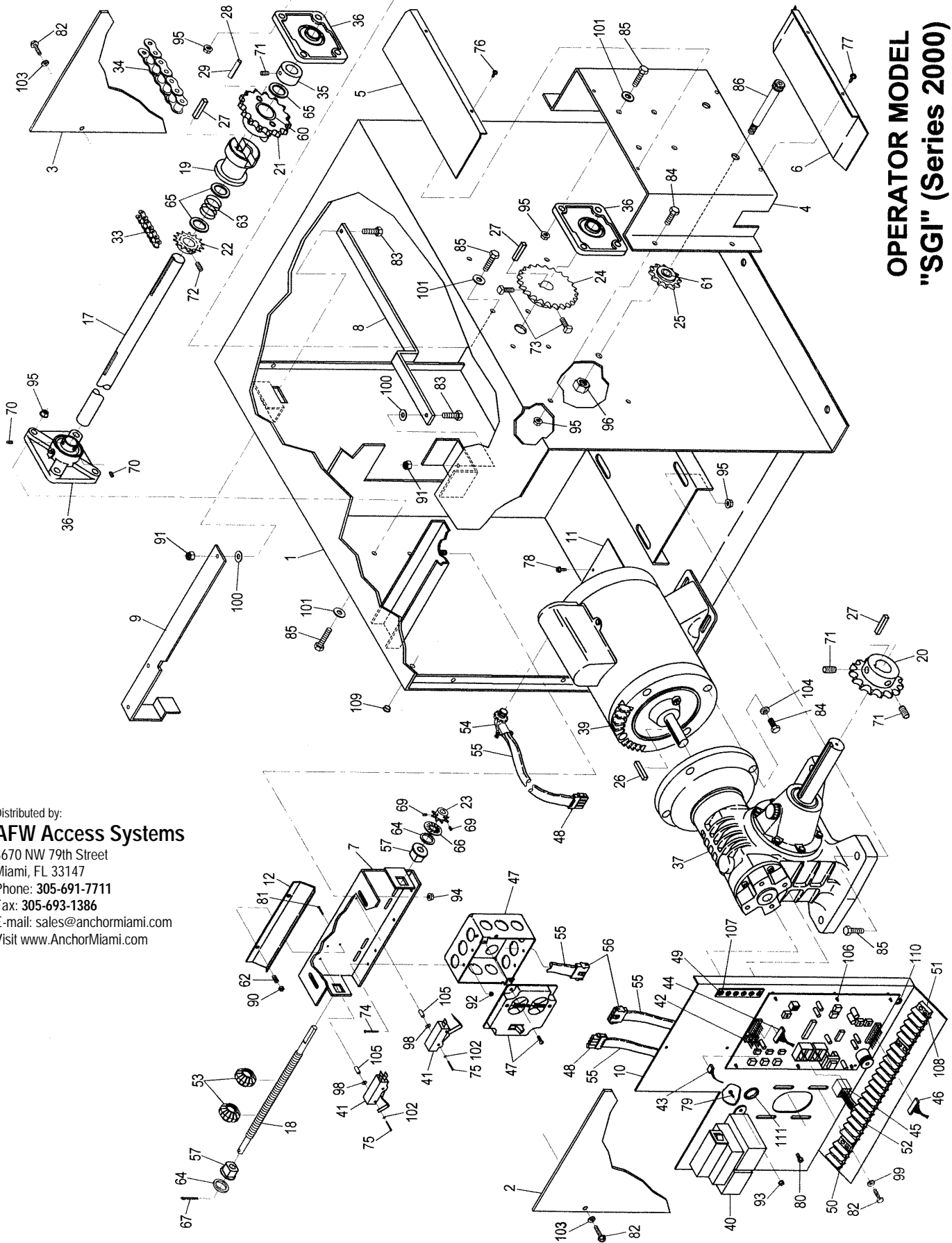

Distributed by:  
**AFW Access Systems**  
3670 NW 79th Street  
Miami, FL 33147  
Phone: 305-691-7711  
Fax: 305-693-1386  
E-mail: sales@anchormiami.com  
Visit [www.AnchorMiami.com](http://www.AnchorMiami.com)

# SGI (Series 2000)

ITEM	QTY.	DESCRIPTION	PARTS #
1	One	Main housing weldment	3701
2	One	Front cover	3808
3	One	Rear cover	3708
4	One	Chain guard housing	3705
5	One	Chain guard top cover	3706
6	One	Chain guard bottom cover	3707
7	One	Limit switch housing	3709
8	One	Disconnect arm	3711
9	One	Disconnect handle	3719
10	One	Electric plate	3738
11	One	Electric access plate	3104
12	One	Limit nut retainer plate	6209
13			
14			
15			
16			
17	One	Drive shaft	3722
18	One	Limit shaft	1014
19	One	Disconnect brass slide	SG-102
20	One	Reducer sprocket	50B15X1"
21	One	Disconnect pinned sprocket	SG-103
22	One	Limit drive sprocket	7331
23	One	Limit driven sprocket	6203
24	One	Output drive sprocket	7313
25	Two	Idler sprocket	50C12X625
26	One	3/16" Square key	SK316X1.375
27	Three	1/4" Square key	SK14X1.375
28	Two	1/4" Roll pin	R25X1
29	Two	3/8" Roll pin	R375X1
30			
31			
32			
33	One	Limit chain	RC65X25
34	One	Intermediate drive chain	RC50X49
35	One	1" Collar	SC-100-R
36	Three	1" Four bolt flange bearing	UCFL20720
37	One	Gear reducer	VE-55
38			
39	One	Motor	10082
40	One	1Ø Transformer	T1/2-2460V
41	Two	Limit switch	LS-AT
42	One	Control board	GSMCB01
43	One	3 Pin wiring harness	3P-HARN
44	One	7 Pin wiring harness	7P-HARN
45	One	8 Pin wiring harness	8P-HARN

# SGI (Series 2000)

ITEM	QTY.	DESCRIPTION	PARTS #
46	One	10 Pin wiring harness	10P-HARN
47	One	4" Square, On/Off switch outlet box	V353D
48	Two	4 Pin male connector	4P-MCON
49	One	4 Position R/C terminal strip	RC/TS-04
50	One	2 Position terminal strip	TS-02
51	One	4 Position terminal strip	TS-04
52	One	14 Position terminal strip	TS-114
53	Two	Limit nut	L-100
54	One	3/8" 90° Connector	801-DC2
55	Four	Insulating tubing	PVI-024
56	Two	4 Pin female connector	4P-FCON
57	Two	3/8" Flange bearing	FB-375
58			
59			
60	One	1" Plain bearing	PBO1012510
61	Two	5/8" Plain bearing	PBO628787
62	Two	Nut guide spring	LC045D3
63	One	Disconnect lever spring	C1225096
64	Two	3/8" Shim	375X0.50
65	Three	1" Shim	1X0.05
66	One	Push-on retaining ring	PS-375012
67	One	Cotter pin	C093X1
68			
69	Two	Socket set screw	1104SSC
70	Six	Socket set screw	1404SSC
71	Three	Socket set screw	3105SSC
72	One	Socket set screw	3110SSC
73	Two	Square head set screw	SQS51618X75
74	Two	Pan head screw	0606MSP
75	Four	Pan head machine screw	0624MSP
76	Two	Hex washer head, type B, sheet metal screw	0804BSW
77	Two	Hex washer head, type B, sheet metal screw	1008BSW
78	Two	Hex washer head, type B, sheet metal screw	1408BSW
79	Two	Hex washer head machine screw	0808MSW
80	Two	Hex washer head machine screw (green)	1106MSW
81	Two	Hex head machine screw	0616MH
82	Twelve	Hex head tap bolt	1410BHT
83	Two	Hex head tap bolt	3116BHT
84	Eight	Hex head tap bolt	3712BHT
85	16	Hex head tap bolt	3720BHT
86	Two	Socket shoulder (stripper ) bolt	6252SS
87			
88			
89			
90	Two	Nylon insert stop nut	06NS

# SGI (Series 2000)

ITEM	QTY.	DESCRIPTION	PARTS #
91	Two	Nylon insert stop nut	31NS
92	Two	Serrated flange hex nut	06NR
93	Two	Serrated flange hex nut	08NR
94	Two	Serrated flange hex nut	14NR
95	20	Serrated flange hex nut	37NR
96	Two	Hex nut	50NF
97			
98	Four	Flat washer	06WSAE
99	Four	Flat washer	14WSAE
100	Two	Flat washer	31WSAE
101	Twelve	Flat washer	37WSAE
102	Four	Lock washer	06WS
103	Eight	Lock washer	14WS
104	Four	Lock washer	37WS
105	Four	Limit switch spacer	60233
106	Six	Plastic stand off	PSO-14
107	Two	Rivet	1624-0041
108	Six	Rivet	SD-46BS
109	One	1/2" K.O. Seal	KOS-50
110	One	1/2" Grommet	G-50
111	One	7/8" Grommet	G-87

Distributed by:

**AFW Access Systems**

3670 NW 79th Street

Miami, FL 33147

Phone: 305-691-7711

Fax: 305-693-1386

E-mail: sales@anchormiami.com

Visit [www.AnchorMiami.com](http://www.AnchorMiami.com)