

Powermaster RSG 2000 Exploded View

Distributed by:
AFW Access Systems
3670 NW 79th Street
Miami, FL 33147
Phone: 305-691-7711
Fax: 305-693-1386
E-mail: sales@anchormiami.com
Visit www.AnchorMiami.com

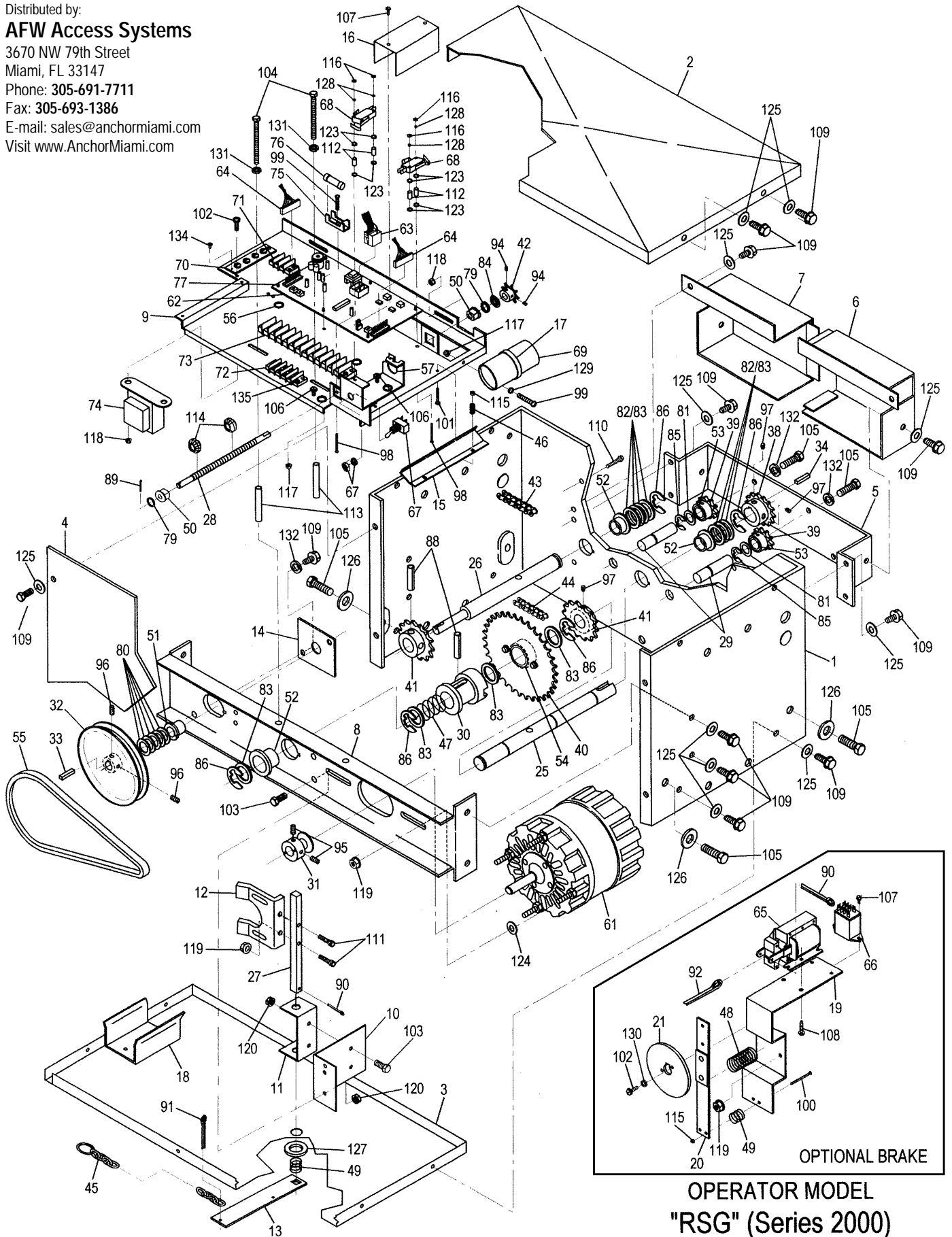

OPERATOR MODEL
"RSG" (Series 2000)

RSG (Series 2000)

ITEM	QTY.	DESCRIPTION	PARTS #
1	One	Housing	4304
2	One	Top cover	4306
3	One	Bottom pan	4305
4	One	Front cover	4307
5	One	Idler brace	3506
6	One	Chain guard (right half)	3505-1
7	One	Chain guard (left half)	3505-2
8	One	Drive frame	4303
9	One	Electric plate weldment	4324
10	One	Disconnect mounting bracket	3507
11	One	Disconnect U-bracket	6213
12	One	Disconnect horseshoe	6214
13	One	Disconnect lever	M-1000
14	One	Lower chain adjusting plate	2215
15	One	Limit nut retainer plate (L/D)	1105
16	One	Junction box cover	4302
17	One	Capacitor strap	1104
18	One	Loop detector bracket (optional)	3704
19	One	Brake mounting bracket (optional)	3521
20	One	Brake bar (optional)	1303
21	One	Brake disc (optional)	TBD-400
22			
23			
24			
25	One	Drive shaft	3514
26	One	Sensitivity shaft	3515
27	One	Disconnect (square) shaft	4317
28	One	Limit shaft	1309
29	Two	Idler shaft	3518
30	One	Brass disconnect	3513
31	One	Motor pulley	AS1550
32	One	Drive sheave	AS6058
33	One	3/16" Square key	SK316X1375
34	One	1/4" Square key	SK14X1375
35			
36			
37			
38	One	Drive sprocket (41B14X1"X1/4"KW)	7320
39	Two	Idler sprocket (41B12X1")	7305
40	One	"J" Pinned sprocket (48B32X112)	7335
41	Two	Sprocket (48B14X1")	7331
42	One	Limit driven sprocket (48B7X3/8")	6203
43	One	Intermediate drive roller chain	RC41X41
44	One	Limit roller chain	RC65X35
45	One	Disconnect chain	8A-12

RSG (Series 2000)

ITEM	QTY.	DESCRIPTION	PARTS #
46	Two	Limit nut guide pressure spring	LC045D3MW
47	One	Disconnect slide return spring	C1225
48	One	Upper brake spring (optional)	LC072L7MW
49	Two	Lower brake/disconnect lever spring (1 optional)	LC055J1MW
50	Two	3/8" Flange bearing	FB-375
51	One	5/8" Flange bearing	FB-625
52	Three	1" Flange bearing	FB-1000
53	Two	3/4" Plain bearing	PBO7510875
54	One	1" Plain bearing	PBO1011210
55	One	V-belt	4L-330
56	Four	1/2" Grommet	G-50
57	One	7/8" Grommet	G-87
58			
59			
60			
61	One	Motor	PSC-50150
62	One	Control board	GSMCB02
63	One	8 Pin wiring harness	8P-HARN
64	Two	10 Pin wiring harness	10P-HARN
65	One	Brake solenoid (optional)	4X240
66	One	Relay (optional)	R24A-SEDPDT
67	One	ON/OFF switch	2GK51-73
68	Two	Limit switch	D44
69	One	Capacitor	CAP-70220
70	One	4 Position R/C terminal strip	R/C-TS-04
71	One	2 Position terminal strip	TS-02
72	One	4 Position terminal strip	TS-04
73	One	14 Position terminal strip	TS-114
74	One	Transformer	T1-2440VA
75	One	Fuse holder	FH-300-20
76	One	10 AMP fuse	F-250-10
77	Six	Plastic stand off	PSO-14
78			
79	Two	3/8" Shim	375-050
80	Five	5/8" Shim	625X050
81	Two	3/4" Shim	750X050
82	As Req.	1" Shim (thin)	1X016
83	As Req.	1" Shim (thick)	1X050
84	One	3/8" Push-on retaining ring	S375012
85	Two	3/4" E-ring	SE-74
86	Five	1" E-ring	SE98-01
87			
88	Two	Roll pin	R312X1.625
89	One	Cotter pin	CO93X1
90	Two	Cotter pin (one for brake optional)	C125X1

RSG (Series 2000)

ITEM	QTY.	DESCRIPTION	PARTS #
91	One	Cotter pin	C125X1.5
92	One	Cotter pin (optional)	C125X2
93			
94	Two	Socket set screw	1104SSC
95	Two	Socket set screw	1404SSC
96	Two	Socket set screw	3104SSC
97	Three	Socket set screw	3105SSC
98	Four	Pan head machine screw	0420MSP
99	Two	Pan head machine screw	0610MSP
100	Two	Pan head machine screw (optional)	0626MSP
101	Two	Hex head machine screw	0616MH
102	Four	Hex head machine screw (2 optional)	0806MH
103	Four	Hex head tap bolt	1410MH
104	Two	Hex head cap bolt	1448CH2
105	Six	Hex head tap bolt	3712BHT
106	Two	Hex washer head, ground screw (green)	1106MSW
107	Four	Hex washer head type, B, sheet metal screw (2 optional)	0804BSW
108	Two	Hex washer head type, B, sheet metal screw (optional)	1408BSW
109	27	Hex washer head type, B, sheet metal screw	3108BSW
110	Two	Hex washer head machine screw	0806MSW
111	Two	Socket head cap screw	1114CSP
112	Four	Limit switch spacer	60233
113	Two	Electric plate mounting spacer	61883
114	Two	Limit nut	L-100
115	Four	Nylon insert stop nut (2 optional)	6NS
116	Four	Hex nut	04NH
117	Two	Serrated flange hex nut	06NR
118	Four	Serrated flange hex nut	08NR
119	Four	Serrated flange hex nut (2 optional)	11NR
120	Four	Serrated flange hex nut	14NR
121			
122			
123	Eight	Flat washer	04WSAE
124	Two	Flat washer	10WSAE
125	23	Flat washer	31WSAE
126	Four	Flat washer	37WSAE
127	One	Flat washer	50WSAE
128	Four	Lock washer	04WS
129	One	Lock washer	06WS
130	Two	Lock washer (optional)	08WS
131	Two	Lock washer	14WS
132	Four	Lock washer	37WS
133			
134	Two	Rivet	1624-00411
135	Six	Rivet	SD-46BS