

Powermaster P1500 Explosion View

Distributed by:

AFW Access Systems

3670 NW 79th Street

Miami, FL 33147

Phone: 305-691-7711

Fax: 305-693-1386

E-mail: sales@anchormiami.com

Visit www.AnchorMiami.com

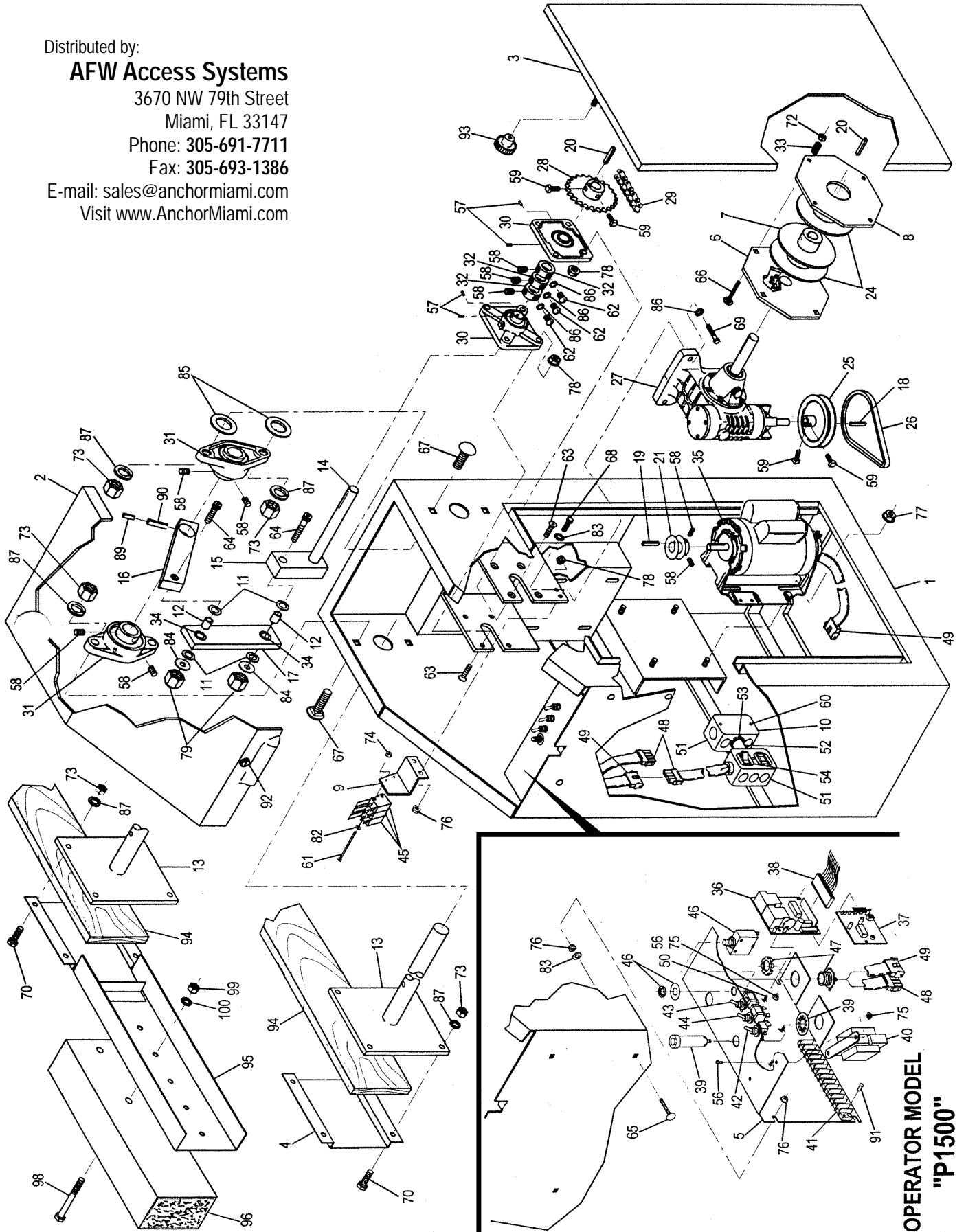

**OPERATOR MODEL
"P1500"**

SBG (P1500)

ITEM	QTY.	DESCRIPTION	PART #
1	One	Main housing weldment	900
2	One	Cover	901-1
3	One	Side door	901-2
4	One	Arm cap	902-1
5	One	Electrical plate	903
6	One	Cluster weldment	1035
7	One	Drive plate weldment	1029
8	One	Pressure plate	1016
9	One	Limit switch bracket	934
10	One	Junction box cover	58C1
11	Four	Brass washer (spacer)	936
12	Two	Bearing spacer	941
13	One	Drive shaft weldment	910
14	One	Intermediate shaft	906
15	One	Lower control arm	904
16	One	Upper control arm	905
17	One	Drive link	935
18	One	3/16" Square key	SK316x1.250
19	One	3/16" Square key	SK316x1.375
20	Two	1/4" Square key	SK14x1.25
21	One	Motor pulley	AS2062
22			
23			
24	Two	Clutch disc	1034CSW
25	One	5" "A" Drive sheave	AS-5062
26	One	V-belt	4L-220
27	One	Gear reducer	LIM-55
28	One	Intermediate sprocket	50B24-1x1/4KW
29	One	Drive chain	50x41
30	Two	1" Four bolt flange bearing	UCF20516
31	Two	1-1/4" Two bolt flange bearing	UCFL20720
32	Three	Limit collar	SC100-L
33	Four	Clutch spring	C120
34	Two	Plain bearing	FB-750
35	One	Motor	100802
36	One	Printed circuit board	PRB
37	One	ACTW board	ACTW3C
38	One	12 Pin wiring harness	12P-HARN

SBG (P1500)

ITEM	QTY.	DESCRIPTION	PART #
39	One	2 Amp resettable fuse	REY0022
40	One	Transformer	TU1-2440VA
41	One	14 Position terminal strip	TB-114
42	One	Timer toggle switch	CB201-37
43	One	On/Off switch (DPDT) (set)	2GK51-73
44	One	Open/close switch (set)	6GM5B-78
45	Three	Double limit switch (#6)	LS-DAT
46	One	1 \emptyset Overload reset switch (set)	MB-07
47	One	Straight connector (set)	501-DC2
48	Two	Mail connector	4PIN-MCON
49	Two	Female connector	4PIN-FCON
50	Five	Plastic stand off	PSO-14
51	Two	Junction box	58361-1/2
52	One	1/2" X 2" Long nipple	6P789
53	Four	1/2" Lock nut	MS7E
54	One	15A, 120V Incoming power switch	W/RECEPTACLE
55			
56	Three	Hex washer head machine screw	0808MSW
57	Four	Socket set screw	1404SSC
58	Nine	Socket set screw	3105SSC
59	Four	Square head set screw	SQ51618X.625
60	Two	Pan head slotted machine screw	0606MSP
61	Two	Pan head machine screw	0640MSP
62	Three	Round head machine screw	1406MSR
63	Eight	Flat head socket cap bolt	3720CSFL
64	Two	Socket head cap bolt	5032CSP
65	Four	Carriage bolt	1424C
66	Four	Carriage bolt	3736C
67	Four	Carriage bolt	5024C
68	Two	Hex head tap bolt	1410BHT
69	Four	Hex head cap bolt	3724CH2
70	Four	Hex head cap bolt	5024CH2
71			
72	Four	Hex nut	37NF
73	Eight	Hex nut	50NF
74	Two	Serrated hex flange nut	06NR
75	Three	Serrated hex flange nut	08NR
76	Ten	Serrated hex flange nut	14NR

SBG (P1500)

ITEM	QTY.	DESCRIPTION	PART #
77	Four	Serrated hex flange nut	31NR
78	Twelve	Serrated hex flange nut	37NR
79	Two	Elastic stop nut	50NS
80			
81			
82	Two	Flat washer SAE	06WSAE
83	Six	Flat washer SAE	14WSAE
84	Two	Flat washer SAE	50WSAE
85	Two	Flat washer SAE	75WSAE
86	Seven	Lock washer	37WS
87	Eight	Lock washer	50WS
88			
89	Two	Roll pin	R218x100
90	One	Roll pin	R375x200
91	Two	Rivet	1624-0041
92	One	Lock cylinder assembly	3795-6T
93	One	Phenolic know	HK-3816
94	One	Arm (length as required)	
		"Following parts are required for operators that require counter weight(s)"	
95	One	Weight carrier bracket	811
96	As Req.	Single counter weight	911
97	As Req.	Double counter weight (not shown)	978
98	As Req.	Hex cap bolt	5064-CH2
99	As Req.	Hex nut	50NF
100	As Req.	Lock washer	50WS

Distributed by:

AFW Access Systems

3670 NW 79th Street

Miami, FL 33147

Phone: 305-691-7711

Fax: 305-693-1386

E-mail: sales@anchormiami.com

Visit www.AnchorMiami.com