

Powermaster CSWI 2000 Exploded View

OPERATOR MODEL
"CSWI" (Series 2000)

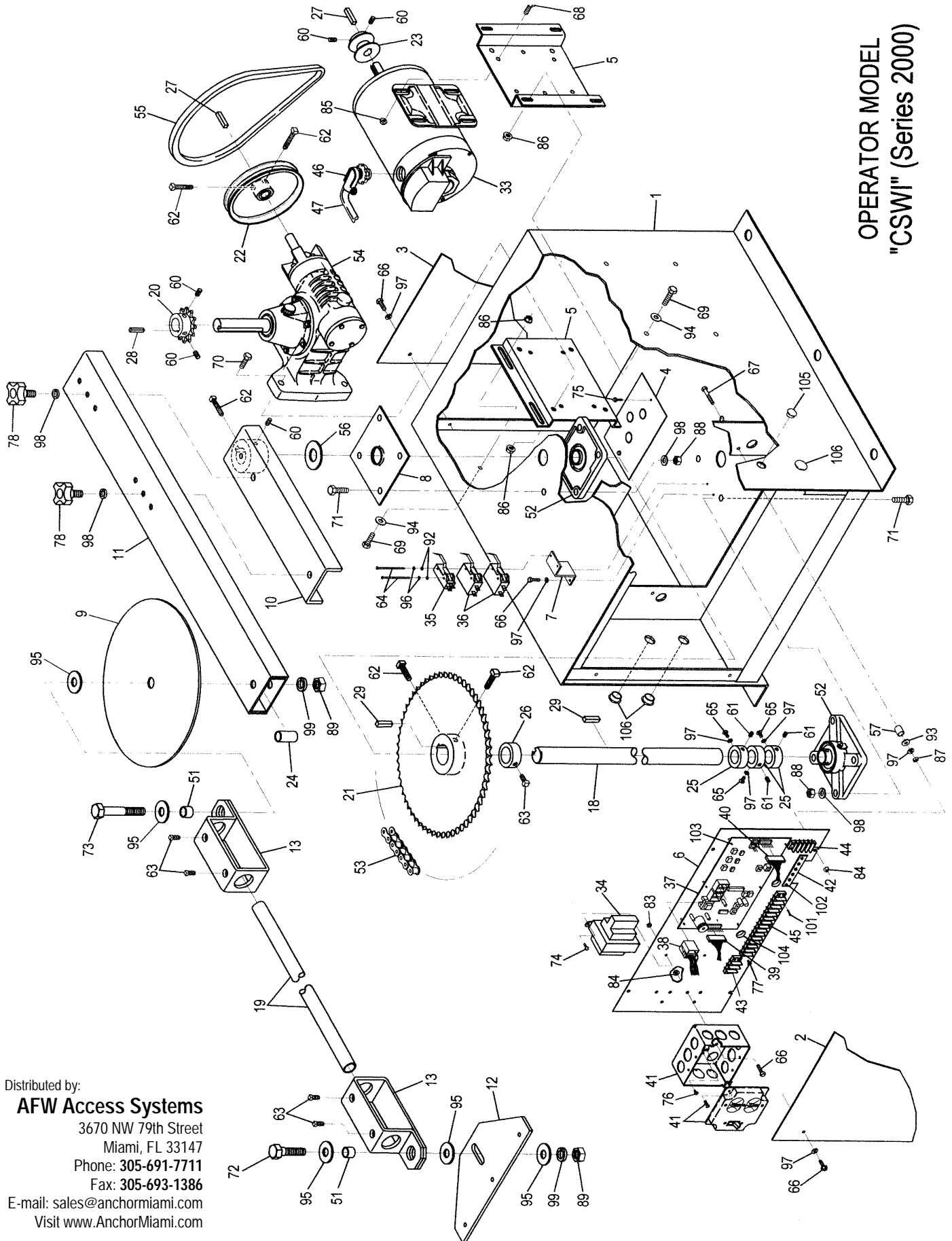

Distributed by:
AFW Access Systems
3670 NW 79th Street
Miami, FL 33147
Phone: 305-691-7711
Fax: 305-693-1386
E-mail: sales@anchormiami.com
Visit www.AnchorMiami.com

CSWI (Series 2000)

ITEM	QTY.	DESCRIPTION	PARTS #
1	One	Main housing weldment	3801
2	One	Front cover plate	3808
3	One	Rear cover plate	3708
4	One	Electrical access plate	3104
5	Two	Motor/reducer mounting bracket	2312
6	One	Electric plate	3802
7	One	Limit switch bracket	3803
8	One	Extruded rain cap	3806
9	One	Anti-pinch disc	3123
10	One	Control arm weldment	1045
11	One	Control arm extension	CSW-1008
12	One	Gate bracket	CSW-1010
13	Two	Pipe knuckle	CSW-1013
14			
15			
16			
17			
18	One	Drive shaft	3809
19	One	Control rod	CSW-1036
20	One	Reducer sprocket	50B12X1"
21	One	Output shaft sprocket	50B60150
22	One	Reducer pulley	BS7058
23	One	Motor pulley	BS2062
24	One	Control arm spacer	3113
25	Three	1-1/2" Limit collar	SC-150-L
26	One	1-1/2" Collar	SC-150-R
27	Two	3/16" Square key	SK316X1.375
28	One	1/4" Square key	SK14X1.375
29	Two	3/8" Square key	SK375X1.125
30			
31			
32			
33	One	Motor	10082
34	One	1Ø Transformer	T1/2-2460V
35	One	Single limit switch	LS-AT-#3
36	Two	Double limit switch	LS-DT-#5
37	One	PC control board	GSMCB01
38	One	8 Pin wiring harness	8P-HARN
39	One	10 Pin wiring harness	10P-HARN
40	One	11 Pin wiring harness	11P-HARN
41	One	4" Square, ON/OFF switch and outlet box	V353D
42	One	4 Position R/C terminal strip	R/C-TS-04
43	One	2 Position terminal strip	TS-02
44	One	4 Position terminal strip	TS-04
45	One	14 Position terminal strip	TS-114

CSWI (Series 2000)

ITEM	QTY.	DESCRIPTION	PARTS #
46	One	3/8" 90° Connector	801-DC2
47	One	Insulating tubing	PVI-024
48			
49			
50			
51	Two	3/4" Plain bearing	PBO-751062
52	Two	1-1/2" Dia. four bolt flange bearing	UCF-207
53	One	Drive chain	RC50X65
54	One	Gear reducer (up to 1HP)	VE-55
55	One	V-Belt	5L-280
56	One	Control arm seal ring	RS-1500
57	Four	Electric plate mounting spacer	60998
58			
59			
60	Five	Socket set screw	3105SSC
61	Three	Socket set screw	3706SSC
62	Five	Square head set screw	SQ51618X1
63	Five	Square head set screw	SQ3816X5/8
64	Two	Pan head machine screw	0640MSP
65	Three	Round head machine screw	1406MSR
66	12	Hex head bolt	1408BHT
67	Four	Hex head cap bolt	1424CH2
68	Four	Hex head tap bolt	3112BHT
69	Eight	Hex head tap bolt	3716BHT
70	Four	Hex head tap bolt	3720BHT
71	Eight	Hex head tap bolt	5024BHT
72	One	Hex head cap bolt	7540CH2
73	One	Hex head cap bolt	7564CH2
74	Two	Hex washer head machine screw	0808MSW
75	Two	Hex washer head, type B, sheet metal screw	1408BW
76	One	Hex washer head (green) thread cutting screw	11063SW
77	One	Hex washer head machine screw (green)	1106MSW
78	Two	Phenolic hand knob	1/2"-13X3/4"LG.
79			
80			
81			
82			
83	Two	Serrated flange hex nut	08NR
84	Six	Serrated flange hex nut	14NR
85	Four	Serrated flange hex nut	31NR
86	12	Serrated flange hex nut	37NR
87	Four	Hex nut	14NF
88	Eight	Hex nut	50NF
89	Two	Hex nut	75NF
90			

CSWI (Series 2000)

ITEM	QTY.	DESCRIPTION	PARTS #
91			
92	Two	Flat washer	06WSAE
93	Four	Flat washer	14WSAE
94	Eight	Flat washer	37WSAE
95	Five	Flat washer	75WUSS
96	Two	Lock washer	06WS
97	17	Lock washer	14WS
98	Ten	Lock washer	50WS
99	Two	Lock washer	75WS
100			
101	Six	Rivet	SD-46BS
102	Two	Rivet	1624-0041
103	Six	Plastic stand off	PSO-14
104	Two	7/8" Grommet	G-87
105	One	1/2" K/O seal	S-50
106	Three	7/8" K/O seal	S-87

Distributed by:

AFW Access Systems

3670 NW 79th Street

Miami, FL 33147

Phone: 305-691-7711

Fax: 305-693-1386

E-mail: sales@anchormiami.com

Visit www.AnchorMiami.com